

SPIRA-TROL

general service control valves



spirax
/sarco

SPIRA-TROL

general service control valves

About the SPIRA-TROL

The SPIRA-TROL has been developed using the very latest in Computational Fluid Dynamics and rapid prototyping techniques to provide a modern valve for today's demanding industries.

The control valve has a modular design concept and incorporates many options within one body envelope. Both ASME (ANSI) and EN versions share the same internals and only three pneumatic actuators are required for valves up to DN200, 8" in size. This leads to a low number of components and a highly flexible system, where one valve can satisfy the needs of numerous industrial requirements. The outcome for the user is a general service control valve with exceptionally low cost of ownership.

A general service
control valve
with a winning formula

General service application
+
Precise control
+
High performance stem sealing
+
Long life internals
+
Low number of components
+
Quick and easy maintenance
=

Low cost of ownership
and higher profits for you

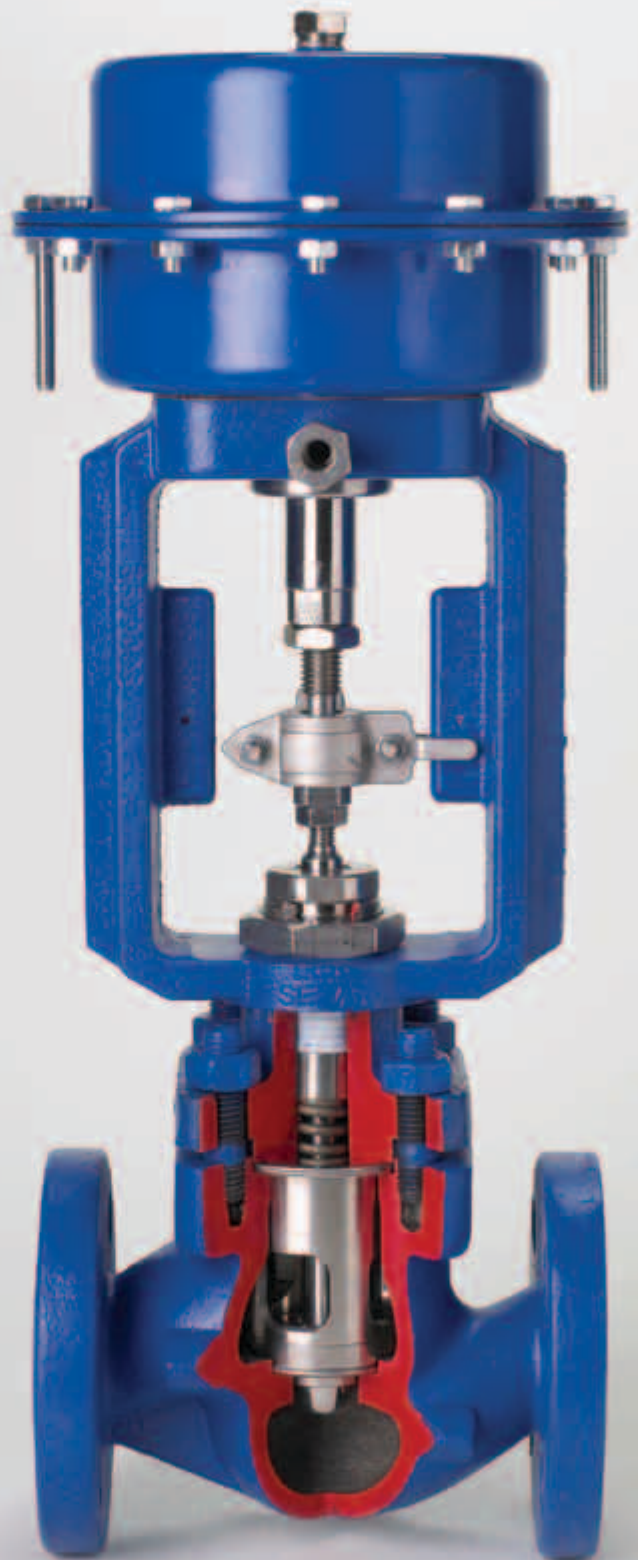

The range at a glance

Valve name	Valve type	Body materials	Valve sizes	Connections	Flow characteristics	Special trims	Stem seals	Actuation	
SPIRA-TROL	2-port globe to ASME (ANSI) or EN	Cast iron	DN15 to DN200	Flanged: ASME 125 ASME 150 ASME 300	Equal percentage	Low noise	Spring loaded chevron and 'O' ring	Pneumatic	
		SG iron	½" to 8"	PN16	Linear	Soft seal	Graphite	Electric	
		Carbon steel			Fast opening	Hard facing		Modulating	
		Stainless steel	PN25 PN40	JIS 10 JIS 20	Reduced flow including microflute	Balanced option	Bellows	Bonnet extension	On / Off
		Socket weld	KS 10 KS 20						

Clamp in place, free float design

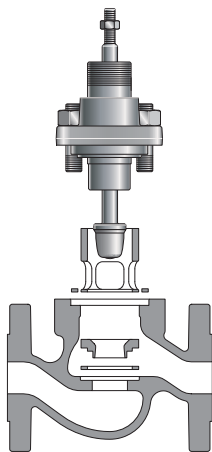

All trim components are designed to clamp in place so the valve can be quickly configured to the user's specific process needs.

The free float of the seat and plug during assembly means that stem, plug and seat alignment is easily achieved.

When compared to alternative designs, the free float design provides the user with longer stem seal life and better valve shut-off performance.

The simplicity of build also means that maintenance is quick and easy, with no special tools required to achieve the design performance of the valve.

- Quick to configure
- No special tools required
- Design performance easily achieved after maintenance

Industries, fluids and applications -

Where the SPIRA-TROL has been frequently used

Industries

Food
Pharmaceutical
Rubber
Electronics
Chemicals
Prisons and educational facilities

Beverages
Medical
Plastics
Metals
Healthcare

Fluids

Saturated steam
Superheated steam
Chilled water
Hot water
Deionised water
Sea water
A variety of other chemicals and gases

Lubricant oils
Nitrogen
Petroleum
Natural gas
Thermal oils
Compressed air

Applications

Temperature, pressure, level, humidity and flow control
Heat exchangers
Pressure vessels
Storage vessels
Unit heaters
Hot water generators

Cooking pans
Reactors
Ovens
Chillers
Humidifiers

Available options

Reduced flow trim

Between three and five reduced flow trims per valve size, with further reductions available to special order, allows precise matching to the process load.



Chevron **Graphite**

Valve stem sealing options include PTFE chevrons and high temperature graphite rings.



Bellows sealed bonnet

Extended bonnets for high and low temperature service and stainless steel bellows for low maintenance, high temperature and zero emission requirements.



Standard **Low noise**

Simple solutions to aerodynamic noise reduction.



Trim

Equal percentage, fast opening and linear flow characteristic for process load matching.

Micro-flute **Soft seal**



Summary of key features and benefits

Key features	Key reasons	Key benefits
 <p>General service application</p>	<p>Many body material options.</p> <p>Large number of trim designs including low noise and micro-flute.</p> <p>Electric or pneumatically operated.</p> <p>Easily interfaced with a control system using:</p> <ul style="list-style-type: none"> - Double mount actuator yoke. - A control valve interface device from Spirax Sarco that includes smart and communicating positioners for use in hazardous and non-hazardous environments. 	<p>Standardised control valve for your plant, which minimises maintenance, training and spares inventory.</p>
 <p>Precise control</p>	<p>Designed using in-house Computational Fluid Dynamics and rapid prototyping to optimise flow paths, flow characteristics and rangeability.</p> <p>Sizing and selection software to determine the most suitable valve configuration.</p> <p>Accurate pneumatic and electric actuators.</p> <p>Optional non-contact feedback positioners.</p>	<p>Excellent control performance across a wide range of applications.</p>
 <p>High performance long life stem seal</p>	<p>Top and bottom guided valve stem ensures excellent alignment and long stem seal life.</p> <p>Scraper ring and dust ring ensures the stem seal is not damaged by the flow media or particles from the atmosphere.</p> <p>'O' ring ensures excellent sealing on low pressure and temperature media.</p>	<p>Low emissions from the valve stem, which means a better environment and no loss of valuable product or energy.</p> <p>Infrequent seal replacement, leaving maintenance personnel free for other work.</p>
 <p>Long life valve internals</p>	<p>Hard trim materials as standard on iron and carbon steel valves.</p> <p>Diffused discharge from the seat and plug reduces the possibility of jet stream damage to the body.</p> <p>Large gallery area reduces the flow velocity, which means reduced body erosion and noise.</p>	<p>Fit and forget.</p>
 <p>Low number of components</p>	<p>Fully modular design through the sizes.</p> <p>ASME (ANSI) and EN valves share the same internals.</p> <p>Two ranges of pneumatic actuators to suit valves up to DN200 / 8".</p>	<p>Highly flexible supply.</p> <p>Minimises spares inventory.</p>
 <p>Quick and easy maintenance</p>	<p>Standard size fixings eliminating the need for specialist tools.</p> <p>Self-aligning, clamp-in-place internals.</p>	<p>Limited plant downtime.</p>
 <p>Low cost of ownership</p>	<p>General service application.</p> <p>Excellent control over a wide range of fluids and conditions.</p> <p>Long service life.</p> <p>Low number of components.</p> <p>Quick and easy maintenance.</p>	<p>Larger profits for you.</p>

Regional sales offices

Northeast

Spirax Sarco, Inc.
7760 Olentangy River Road
Suite 120
Columbus, OH 43235
Phone: (614) 436-8055
Fax: (614) 436-8478

Midwest

Spirax Sarco, Inc.
1500 Eisenhower Lane
Suite 600
Lisle, IL 60532
Phone: (630) 493-4525
Fax: (630) 724-9176

Mid Atlantic

Spirax Sarco, Inc.
4647 Saucon Creek Road
Suite 102
Center Valley, PA 18034
Phone: (800) 251-7676
Fax: (800) 996-3232

Southwest

Spirax Sarco, Inc.
203 Georgia Avenue
Deer Park, TX 77536
Phone: (281) 478-4002
Fax: (281) 478-4615

Southeast

Spirax Sarco, Inc.
400 Northeast Drive, Unit O
2021 Business Center
Columbia, SC 29203
Phone: (803) 714-2131
Fax: (866) 339-5356

West

Spirax Sarco, Inc.
8141 E. Kaiser Blvd., Suite 311
Anaheim Hills, CA 92808
Phone: (800) 883-4411
Fax: (714) 940-0183



In our century-long commitment to sustainable energy use in buildings and industry, we dedicate our innovative expertise, products, services and business efforts to conserve our valued natural resources, and will actively guide our customers in attaining these same goals:

- Energy - Minimize energy demand, carbon footprint, emissions and maintenance;
- Balance - Apply energy precisely, recovering and reapplying low-grade energy, conserving wherever possible for future use;
- Flow - Precisely regulate fluid flow to optimize energy consumption, for consistent interior comfort and process control accuracy.

 Printed on recycled paper from sources that have been independently certified for sustainable and well-managed forestry practices.



SPIRAX SARCO, INC.
1150 NORTHPOINT BLVD.
BLYTHEWOOD, SC 29016
t: 800.883.4411
or: 803.714.2000
f: 803.714.2222
www.spiraxsarco.com/us

spirax
sarco

© Copyright 2010 Spirax Sarco, Inc.

